

# Request for Quotation

عرض الاسعار

FROM من	NORWEGIAN REFUGEE COUNCIL
Address العنوان	Sudan – Gadarif – East Aljbarab
City المدينة	Gadarif
Country الدولة	Sudan
Phone # الهاتف	
Email بريد الكتروني	<a href="mailto:sd.procurement.gadarif@nrc.no">sd.procurement.gadarif@nrc.no</a>

TO الى العمل \ الشركة	
Address العنوان	
City المدينة	
Country الدولة	
Phone # الهاتف	
Email بريد الكتروني	

The office of the Norwegian Refugee Council invites your company to submit a price quotation for the following items in accordance with the requirements detailed below. You may use your company format, or fill up the table below. Please read carefully the instructions on page 7

Request for Quotation Requirements (To be filled by NRC Procurement staff)			
Semi permanent latrine – in Abo Al Naja 4			
RFQ # : عرض الاسعار	PF - GAD-682- 027 - - PR 8501432	Currency العملة	
RFQ Issuing Date: تاريخ الاصدار	27/05/2025	Bid Validity Period (days): (Preferably 30 days) صلاحية السعر المنظمة تفضل 30 يوم	
RFQ Closing Date: تاريخ الاغلاق	02 /06/2025	Required Delivery Date: (التنفيذ) زمن التوصيل	
RFQ Closing Time: زمن الاغلاق	14:00 PM	Required Delivery Destination: جهة التسليم	NRC office – Gadarif – East Jubarab
Questions to the RFQ للاستفسار	<a href="mailto:sd.procurement.gadarif@nrc.no">sd.procurement.gadarif@nrc.no</a>	Required Delivery Terms: شروط التسليم المطلوبة	

<div>NRC</div> <div>NORWEGIAN REFUGEE COUNCIL</div>	Bill of Quantity - Construction of semi permanent latrine clock (total of 2 stances) The latrine consists of two stances, total dimensions of 2.0 x 2.0 meters				
GENERAL INSTRUCTIONS	By populating and pricing the BoQ items below, the tenderer certifies and confirms its complete acquittance with and understanding of the site conditions, scope of work, designs, specifications, BoQ, the prevailing market conditions and the local laws and regulations. All and any other items not priced hereunder shall be deemed part of the unit rate pricing all works should be done according to the code of practice, engineering standards and the instruction/ satisfaction of NRC.				
MASONRY INSTRUCTIONS	The work include supply material and construct masonry works, the supply of material include red cured bricks, stones, cement, sand, gravel, reinforcement steel, water, all water supply equipment, skilled and unskilled labours, etc., and curing after building and any other work requirements, all works should be done according to the instruction of NRC				
BILL OF QUANTITIES OF SEMI PERMANENT LATRINE					
Number	DESCRIPTION	UNIT	QTY	Unit Price	Amount
1	Subsurface structure				
1.1	Excavation and removal of any type of soil including all hard and rock layers, temporary earth work supports, depth of excavation = 3.0m and diameter of 2.2m as per drawings and engineer instructions.	m3	11.40		
1.2	Excavation and removal of any type of soil including all hard and rock layers, temporary earth work supports, to an extended depth of 1.0m, and diameter of 1.6m as per drawings and engineer instructions.	m3	2.01		
1.3	Provide and lay granular fill of approved inert materials, well watered and compacted as external protection for the lined pit. Filling around the lining wall, under the ring beam and surrounding the pit cover slab as per drawings and engineer instructions.	m3	4.5		
1.4	Provide and lay granular soil for flood protection of approved inert materials well watered and compacted. Filling around the surrounding the super-structure as per drawings and engineer instructions.	m3	2.5		

1.5	supply materials, cast and build 1.5 Red brick retaining wall with cement and sand mortar 1:6 including (sealant, grouts and insulation if needed) to depth of 3 meters below ground level and according to the design, technical specifications and engineer satisfaction	m2	20.72		
1.6	Supply and apply cement / sand plaster; 20 mm thickness in two layers, 1:6 cement : sand mix finished smooth at the internal walls of latrine pit. as per design, technical specifications and to NRC satisfaction.	m2	20.72		
1.7	Supply, cast and plaster in smooth layer, selected and imported good quality water proof coat for internal latrine pit walls, water proof material shall recognized and proofed quality (preferable Betamin or Sika top seal), rates shall include all necessary labour costs other materials, as per design, engineer instructions and NRC satisfaction.	m2	20.72		
1.8	supply and cast of reinforced concrete ring beam under retaining wall from Grade 30 in 1:2:4 concrete mix, to dimensions of 0.3*0.3m reinforced with 4 main reinforcement steel T10 and canes of T8@150mm C/C, supply and cast the required concrete using mechanical vibrators, cutting, testing and all other requirements and workmanships according construction drawings, Technical Specification to NRC satisfaction	m3	0.621		
<b>2</b>	<b>Super Structure</b>				
2.1	Supply and cast of reinforced concrete cover slab (12cm thickness), mix 1:2:4 reinforced by round steel T10mm @15cm C/C, both ways, supply and cast the required concrete using mechanical vibrators, cutting, testing and all other requirements and workmanships according to construction drawings, Technical Specification to NRC satisfaction	m3	0.48		

2.2	Supply materials, erect and fix in position side partitions of 2.0m high for latrine superstructure, with main skeleton frame of 4x8 rectangular steel pipes (poles) fixed to depth of 50cm using 1:3:6 plain concrete (4 number) and 3x6 horizontal bracing at level of 0.2m, 1.0m and 1.9m, covered by 0.35mm coregulated sheet according to construction drawings, Technical Specification to NRC satisfaction	m2	16		
2.3	Supply materials, erect and fix in position 2.4*2.0m steel roof, with main skeleton frame of 3x6 rectangular steel frame fixed on the 4x8 skeleton poles, covered by 0.35mm corrugated sheet, costs shall include all necessary welding joining and bolts. according to construction drawings, Technical Specification to NRC satisfaction	m2	4.8		
2.4	Supply materials, erect and fix in position 2.0x1.0m steel door with frame of 3x6 rectangular steel pipe and 2x4 bracing, cost shall include all necessary welding and bolts. Also installation of internal and external locks according to construction drawings, Technical Specification to NRC satisfaction	no	2		
2.5	Supply and erect 4" PVC ventilation pipe fixed on cover slab to level above toilets roof with 30cm, work shall include all necessary fittings, elbows, anchoring and mesh cover according to drawings, technical Specification and to NRC satisfaction	no	1		
<b>Total amount</b>					

**Remark**

Items and description in BoQ are estimated for construction of new semi permanent latrine block of 2 stances

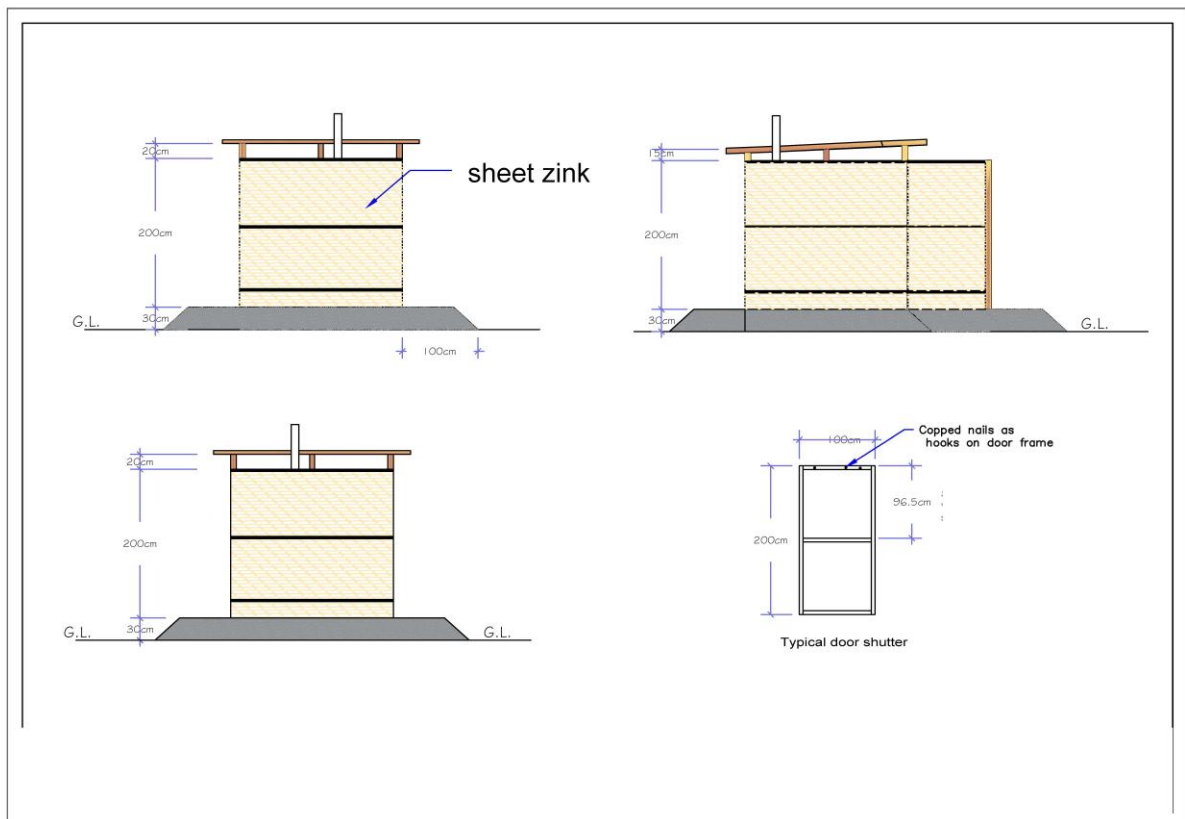
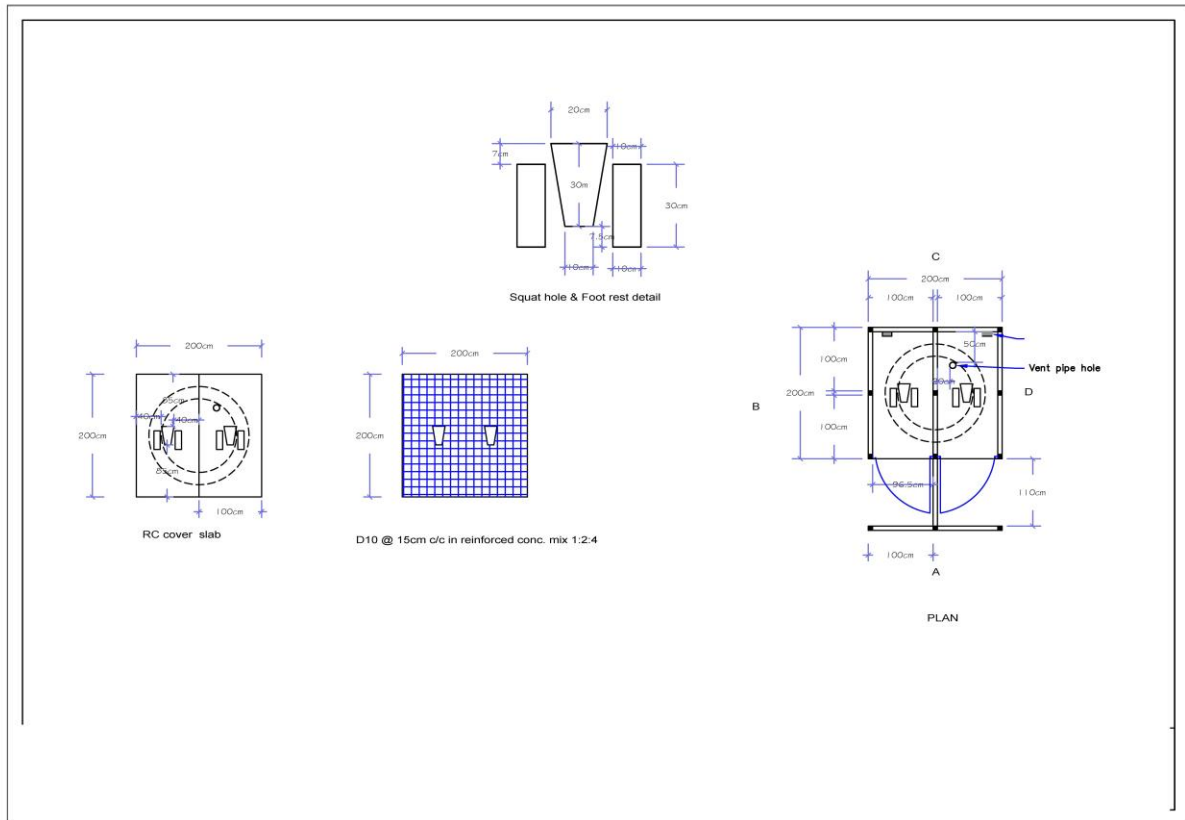

Delivery Lead Time (in days, from receipt of NRC Purchase Order) فترة التوصيل أو التنفيذ بالايام	
Bid Validity Period (in days from receipt of NRC Purchase Order): صلاحية السعر بالايام بعد التوقيع على امر الشراء	
Defects liability and guarantee period: فترة الضمان ملحوظة ( للاجهزة والمعدات والانشاءات )	
Country of origin of the goods بلد المنشأ او الانتاج ان وجد	

Name الاسم	
Position الوظيفة	
Date Signature Stamp التاريخ - التوقيع - الختم	

### RFQ Terms & Conditions

#### Manner of Submission:

By email to the dedicated and secured email address

[sd.procurement.gadarif@nrc.no](mailto:sd.procurement.gadarif@nrc.no)

- (offers received on other email addresses will not be considered)
- Before the Closing date & Time mentioned above. Companies who do not submit their quotation by this deadline will not be considered

#### Requirements:

- All Bids must include all customs and taxes payable in the country of delivery unless the RFQ specifically requests differently
- Bids must be submitted in the currency indicated in the RFQ. Bids in other currency might not be accepted
- Bids must be valid for the validity period indicated in the RFQ. Bids not meeting this validity period might be disqualified
- All enquires and questions should be addressed to the email given in the RFQ details section. All questions and answers will be shared with all invited suppliers.
- NRC reserves the right to accept or reject the whole or part of your quotation based on the information provided. Incomplete quotations which do not comply with our conditions will not be considered.

#### Mandatory documents:

Requested document	Check (Y/N)
Company registration Certificate شهادة تسجيل	
Vat Registration Certificate التسجيل في القيمة المضافة	
Tax registration certificate الرقم التعريفي الضريبي	

Passport Copy / ID of company director \ صورة من إثبات الشخصية \ جواز بطاقة قومية	
Copies of relevant Experience relevant Activates خبرة سابقة في المجال ان وجد	
NRC RFQ to be signed and stamped in each page في التوقيع والختم في كل الصفحات	
Technical Specification photo attached صورة مرفقة من المواصفات الفنية	
Ethical Standards Signed and Stamped المعايير الاخلاقية توقع وتختتم لمن يرسو اليه المناقصة او العطاء	

#### **Assessment Criteria:**

- All bids received and accepted will be evaluated based on the following:
- **Step 1:** Administrative compliance check: Each bid will be checked to ensure compliance with all the RFQ requirements
- **Step 2:** Technical Evaluation: All bids will be technically evaluated based on “best value for money”
- **Step 3:** Financial Evaluation: Price in comparison to NRC established expectation and in comparison, to other bidders of comparable technical quality

#### **Payment terms:**

- Payment will be made within **30 days** of receipt of goods, by **bank transfer/cheque only**.  
سيتم الدفع خلال 30 يوم بعد استلام المواد أو انجاز الاعمال بواسطة التحويل البنكي أو الشيك

<p>NRC is obliged to ensure that its procurement decisions are clearly justified and documented and keeping within the Donors mandatory principles. In that regard, full and on-the-spot access must be granted to representatives of NRC, the Donor or any organisation or person mandated by it, to premises belonging to NRC or its contractors. The right to access shall include all documents and information necessary to assess, or audit the implementation of the contract.</p> <p>NRC also expects suppliers who process personal data to comply with the General Data Protection Regulation (EU GDPR) and any relevant national legislation. Suppliers processing personal data on an NRC contract will be required to sign a data processing / sharing agreement as part of the contract. Refusal to sign such an agreement constitutes refusal of the contract terms and forfeiture of the contract on the part of the supplier.</p> <p>If the activities of the contract take place in areas with Explosive Hazards, NRC accepts no liability for injury and/or death to contractor's staff or damage to contractor's property.</p>	<p>Anti-money laundering, anti-bribery, anti-corruption and anti-terrorism legislation and donor regulations require NRC to screen contractors against various international lists to ensure due diligence. Submission of the quotation constitutes acceptance of these screening practices.</p> <p>NRC aims to purchase products and services with minimum environmental impact. Environmental considerations form part of the NRC selection criteria, and NRC reserves the right to reject quotations provided by suppliers not meeting these standards.</p> <p>All suppliers doing business with NRC should maintain high standards on ethical and environmental issues, respect and apply basic human and social rights, ensure non-exploitation of child labour, and give fair working conditions to their staff. <b><u>Suppliers will be required to sign and submit an Ethical Standards Declaration, together with their bid.</u></b></p> <p>NRC reserves the right to reject quotations provided by suppliers not meeting these standards.</p>
--	---